



n.b. verify all measurements on site. do not make from the drawing. see brief revision.

THIS PLAN HAS BEEN REVISED BY OR WITH THE AGREEMENT OF THE CLIENT. ALL MEASUREMENTS AND DIMENSIONS ARE TO BE CHECKED ON SITE. THE CONTRACTOR SHALL BE RESPONSIBLE FOR VERIFYING ALL DIMENSIONS AND DIMENSIONS OF THE CONTRACTOR'S WORK.

REVISED PLAN



settling tank to be dredged on a routine basis and investment mix mechanically dredged and stored directly into slips ready to be carted away for recycling

waste water recycling lagoons - water containing investment mix pumped to 45 ton settling tank and gravity fed to secondary bed filter lagoons via weirs and clean water again pumped back to below ground holding tank, low level bund wall to lagoons

1 Sygatech - Proposed Site Layout Scale: 1:500

DATE 04/08/16

rev 8 minor adjustments 28.07.16
rev 9. alterations added 08.08.2016 14



job:
SYLATECH PICKERING PLANT

title:
PROPOSED SITE PLAN

date: SEPT 2015	scale: 1:500 @A1 1:1000 @A3
sheet no: 087 / 3.02	box: B



THIS PLAN HAS BEEN MADE BY ME AS AN EXPERT AND I AM NOT PROVIDING ANY GUARANTEE AS TO THE ACCURACY OF THE INFORMATION CONTAINED HEREIN. I AM NOT PROVIDING ANY GUARANTEE AS TO THE ACCURACY OF THE INFORMATION CONTAINED HEREIN. I AM NOT PROVIDING ANY GUARANTEE AS TO THE ACCURACY OF THE INFORMATION CONTAINED HEREIN.

n.b. verify all measurements on site, do not scale from this drawing, use latest revision.



DATE
04/08/16

Rev B: Sylatech plan updated 28 07 16
Rev A: gate/pond closed 22 01 16

bransdåle lodge
bransdåle
pickering
york YO62 7JL
t: 01173 431137
f: 0870 5225269
e: fred@fredcollin.com or david@fredcollin.com

job:
SYLATECH
THORNTON ROAD
PICKERING

title:
PROPOSED NEW
DEVELOPMENT
ZONE MASTERPLAN

date:
SEPT 2015
date no.
087 / 3.01

scale:
1:1000 @A2
1:2000 @A4
rev:
B

REVISED PLAN

THORNTON ROAD INDUSTRIAL ESTATE

SYLATECH THORNTON ROAD PICKERING
 FULL AND OUTLINE PLANNING APPLICATION BOUNDARIES
 DATE 04/08/16



n.b. verify all measurements on site. do not scale from this drawing. use latest revision.



Rev A: Sylatech plan updated 28/07/16

fred collin architect
 brandstade lodge
 brandstade
 fadmoor
 york YO62 7JL
 t: 01774 431127
 f: 0870 5223269
 e: fre@fredcollin-architect.co.uk

job:
 SYLATECH
 THORNTON ROAD
 PICKERING

title:
 FULL AND OUTLINE
 PLANNING
 APPLICATION
 BOUNDARIES

date:
 SEPT 2015

date no.
 087 / 3.09

scale:
 1:1000 @A2
 1:2000 @A4

rev:
 A

REVISED PLAN

THORNTON ROAD INDUSTRIAL ESTATE

THIS PLAN IS A PRELIMINARY DESIGN AND IS SUBJECT TO APPROVAL BY THE LOCAL AUTHORITY. IT IS NOT TO BE USED FOR CONSTRUCTION WITHOUT THE NECESSARY APPROVALS.

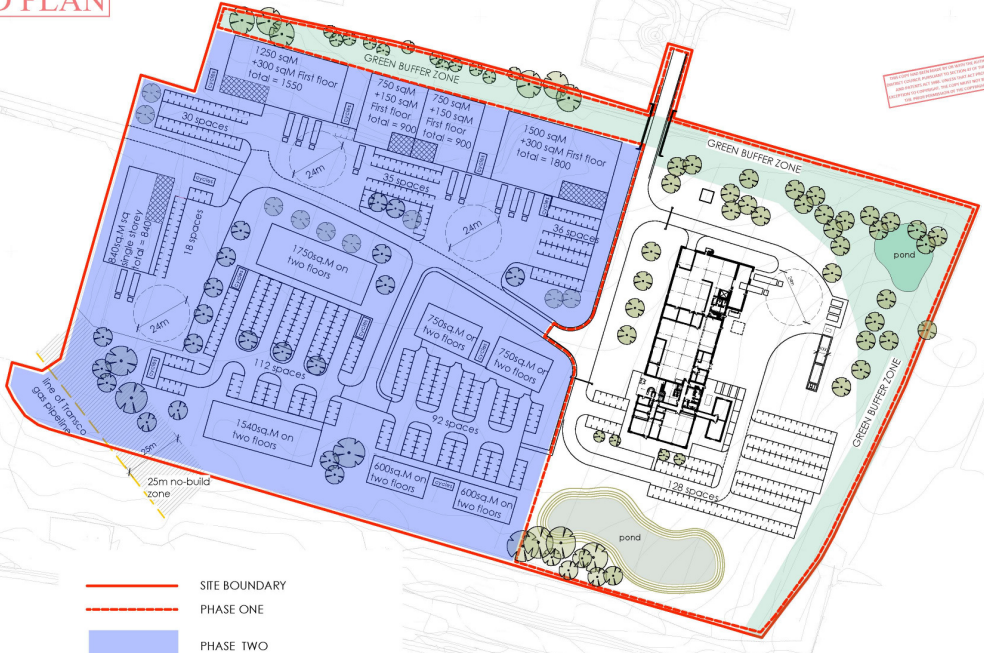

- SITE BOUNDARY
- PHASE ONE
- PHASE TWO

n.b. verify all measurements on site. do not scale from this drawing. use latest revision.



Rev A: Syllatech plan updated 28/07/16

fred collin architect
 bransdale lodge
 bransdale
 factmoor
 york YO22 7JL
 t: 01753 431137
 f: 0870 5222859
 e: fred@collin-architect.co.uk

job:
**SYLATECH
 THORNTON ROAD
 PICKERING**

title:
PHASING PLAN
 DATE
04/08/16

date: SEPT 2015	scale: 1:1000 @A2 1:2000 @A4
dwg.no: 087 / 3.10	rev: A